

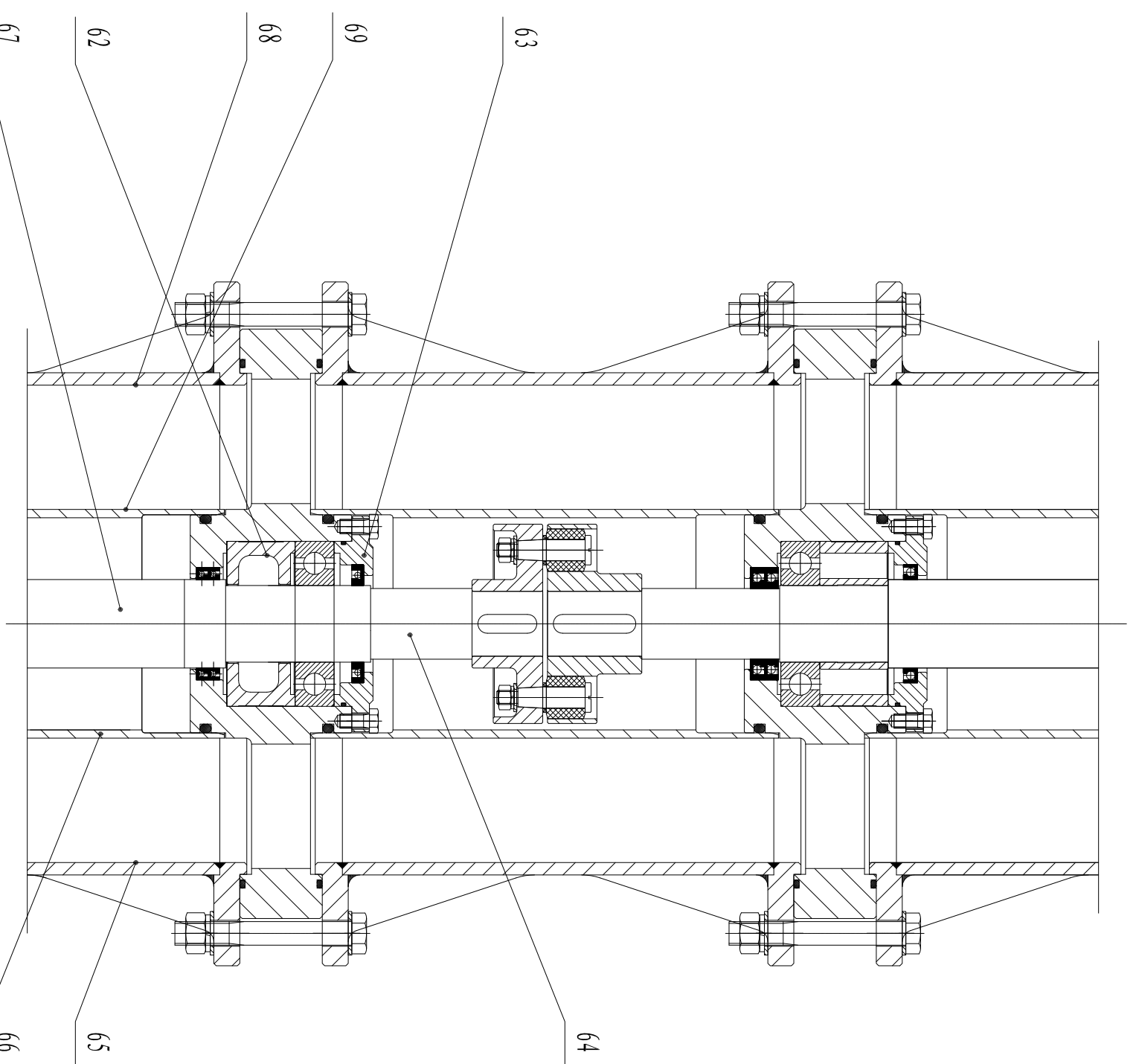

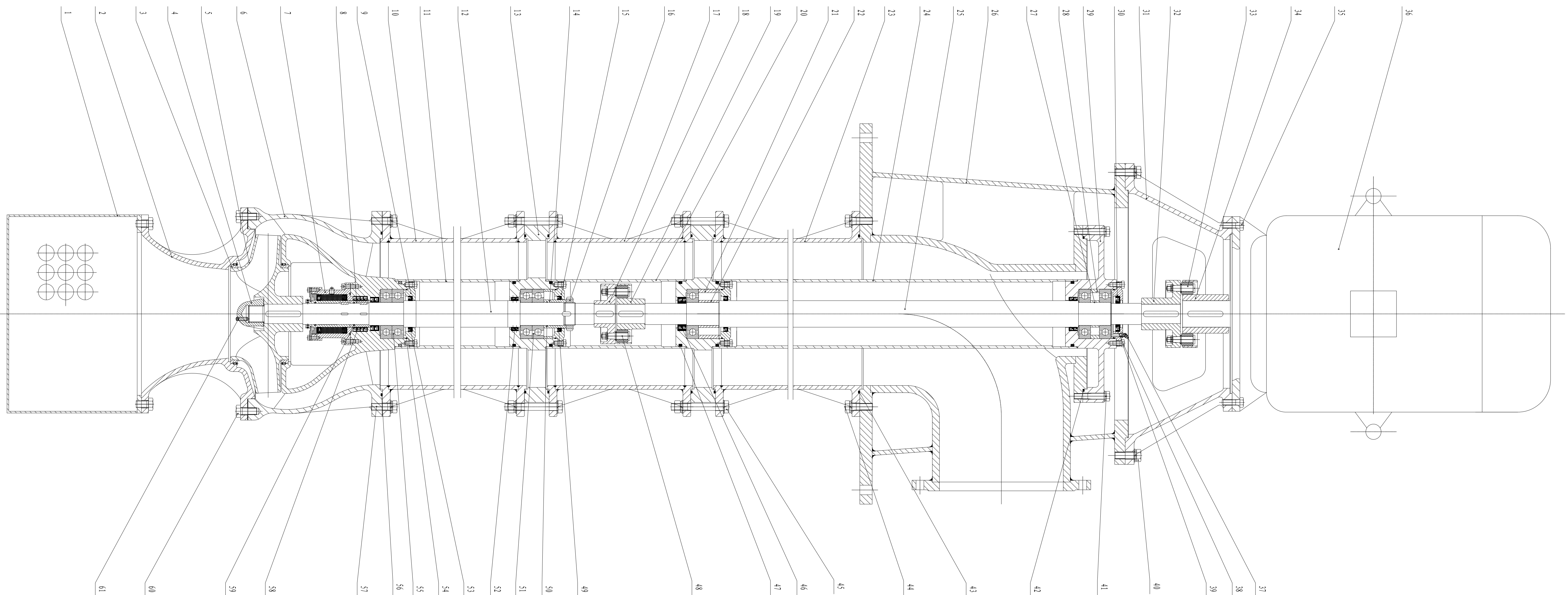

1. Should be read carefully before assembly drawings and technical requirements.
2. The seals must be soaked with oil before assembly, the assembly process of parts are not allowed to knock, touch, scratches and corrosion.
3. Assembly allows the used engine oil heating for hot charging rolling bearing, oil temperature shall not exceed 100 ℃.
4. Enter the assembly of parts and components (including purchased parts and outsourcing parts), all must have the certificate of inspection departments to undertake assembly.
5. Parts must be clean before assembly and clean, no burr, flash, scale, rust, chip, oil, stain and dust, etc.
6. Respond to zero before assembly, main parts with sizes, especially interference fit the size and the related accuracy for review.
7. Screw, bolt and nut fastening, do not hit or use inappropriate whorls and wrench. After fastening screw groove, nuts and bolts, The bolt head is allowed to damage.
8. Fluct key contact with the shaft keyway on the two sides should be uniform, the fitting surface can not have clearance.
9. Bearing outer ring assembly after contact with the positioning end bearing cap end should be uniform, rolling bearing installed by hand after the rotation should be flexible, smooth.
10. Lower the requirement of rotor dynamic balance test, the amount of unbalance shall not be greater than 3 g. When removing unbalance, only to the impeller Houslaban for cutting.
11. When the water pump assembly, each time in pump assembly concentricity must be concentricity inspection after parts, range is 0.02-0.035 mm.
12. After purchasing single row angular contact ball bearings to procurement in pairs. Bearing brands in addition to the special requirements, shall be the wafangjiong bearing or seiko bearings.
13. After completion of assembly, a hydrostatic pressure test, pressure of 10 MPa, duration shall not be less than 10 minutes, at the same time, the parts may not have water, sweat, etc.



70		Name card	1	Unmarked/stainless steel	
71	3J0MDC-50/6, I=42	Protecting tube	2	316L	
69	3J0MDC-50/6, I=41	Connecting pipe	2	316L	
68	3J0MDC-50/6, I=40	ax-1s	2	45#	
67	3J0MDC-50/6, I=39	Protecting tube	1	316L	
66	3J0MDC-50/6, I=38	Connecting pipe	1	316L	
65	3J0MDC-50/6, I=37	ax-1s	1	45#	
64	3J0MDC-50/6, I=36	Bearing gland 1	3	HT-20	
63	3J0MDC-50/6, I=35	Bearing washer	3	HT-20	
62	3J0MDC-50/6, I=35	Six graded seal sets set	1	316L	
61		Hexagon head bolts	12	316L	
59		or-Tlugs			
58		Skeleton oil seal	1	VITON(CTT)	
57		Hexagon head bolts	12	316L	M2KX60
56		or-Tlugs			
55		Deep groove ball bearing	11	SKF	6313
54		or-Tlugs			
53		Skeleton oil seal	5	VITON	
52		Skeleton oil seal	10	VITON	
51		High modulus spring	2	SKF	7513B-DP
50		or-Tlugs			
49		Skeleton oil seal	1	VITON	
48	M1-DIA-002	Circular column pin	24	45#	
47		or-Tlugs			
46		Skeleton oil seal	10	VITON	
45		Hexagon head bolts	96	316L	M2KX150
44		Hexagon head bolts	12	Q235-A	M2KX65
43		or-Tlugs			
42		or-Tlugs	17	VITON	
41		Hexagon head bolts	8	Q235-A	M1KX90
40		Hexagon head bolts	12	Q235-A	M2KX60
39		Hexagon head bolts	4	Q235-A	M2KX60
38		Skeleton oil seal	3	VITON	M2KX35
37		Limit stop pressure ring	1	Gx	M10
36		The motor	1		M1K50
35	3J0MDC-50/6, I=34	Hexagon head bolts	8	Q235-A	
		Motor coupling			

[illegible][illegible]

 EMCORP CONSULTING CO., LTD.	POWER ENGINEERING CONSULTING JOINT STOCK COMPANY 2	
	DONGPHANG ELECTRIC CORPORATION LIMITED	
 ZIGONG HONGDANG PUMP CO., LTD.	Zigong Hongdang Pump Co., Ltd	
 JINGMEN ELECTRIC CO., LTD.	Jingmen Electric Co., Ltd	
DESIGN NO.	DPTEN HAI / HD / MAN1050	
DES. REF. NO.	DPTEN HAI / HD / MAN1050	
WAPU REF. NO.	MAN1050	
PROJECT	DPTEN HAI / THERMAL POWER PLANT PROJECT	
CONTRACT NO.:	DH-3002010	

TITLE 1 : ROTATING SCREEN FLUSH WATER PUMP